

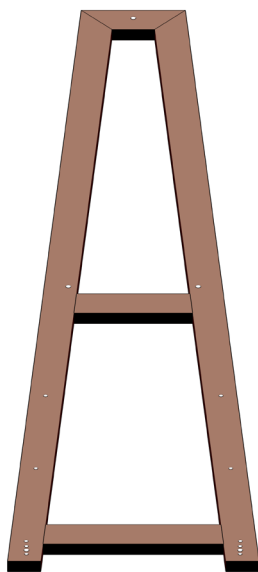

URBAN MODUS

STEP:- 1

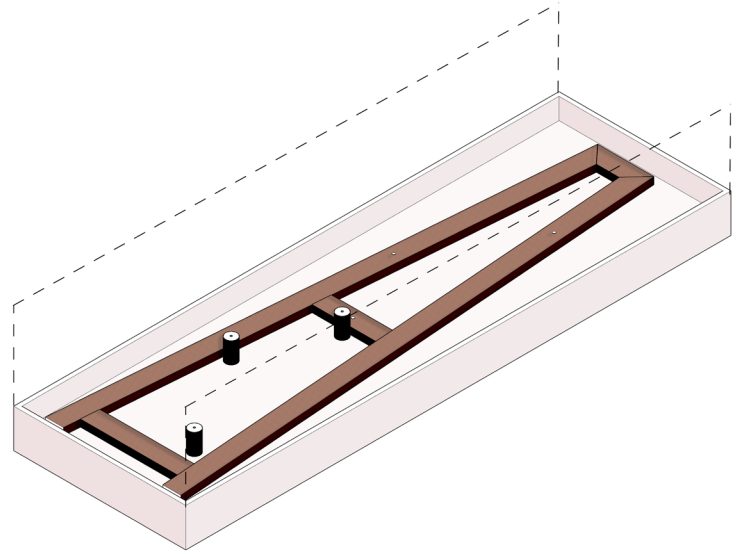

F3

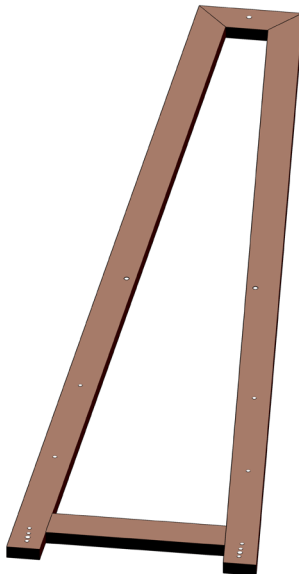

F2

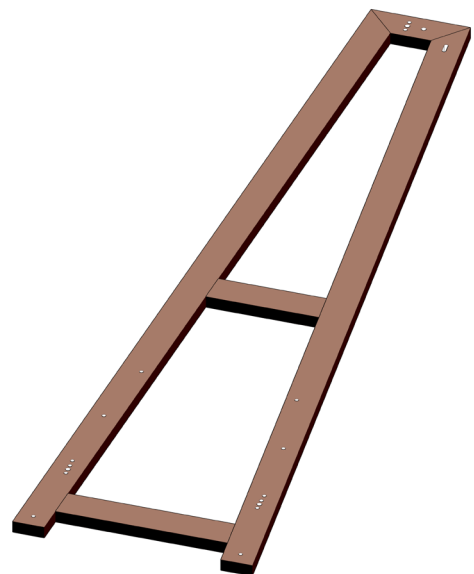

F1

Step 1:Unpack and Check Parts

Carefully remove all parts from the box.

Refer to the checklist and make sure all components and hardware are present before starting assembly.

STEP:- 2

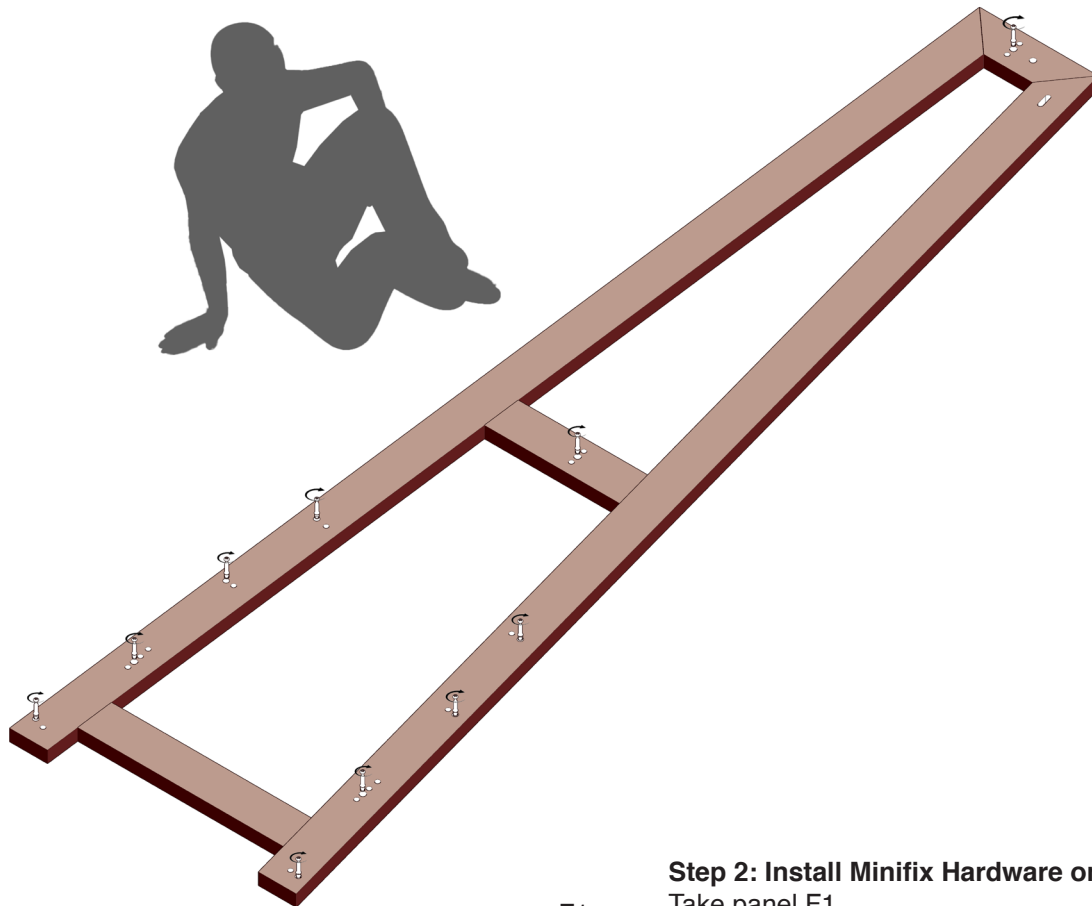

F1

Step 2: Install Minifix Hardware on F1

Take panel F1.

Using a screwdriver, insert and tighten the minifix hardware into all holes that already have white plastic fittings.

STEP:- 3

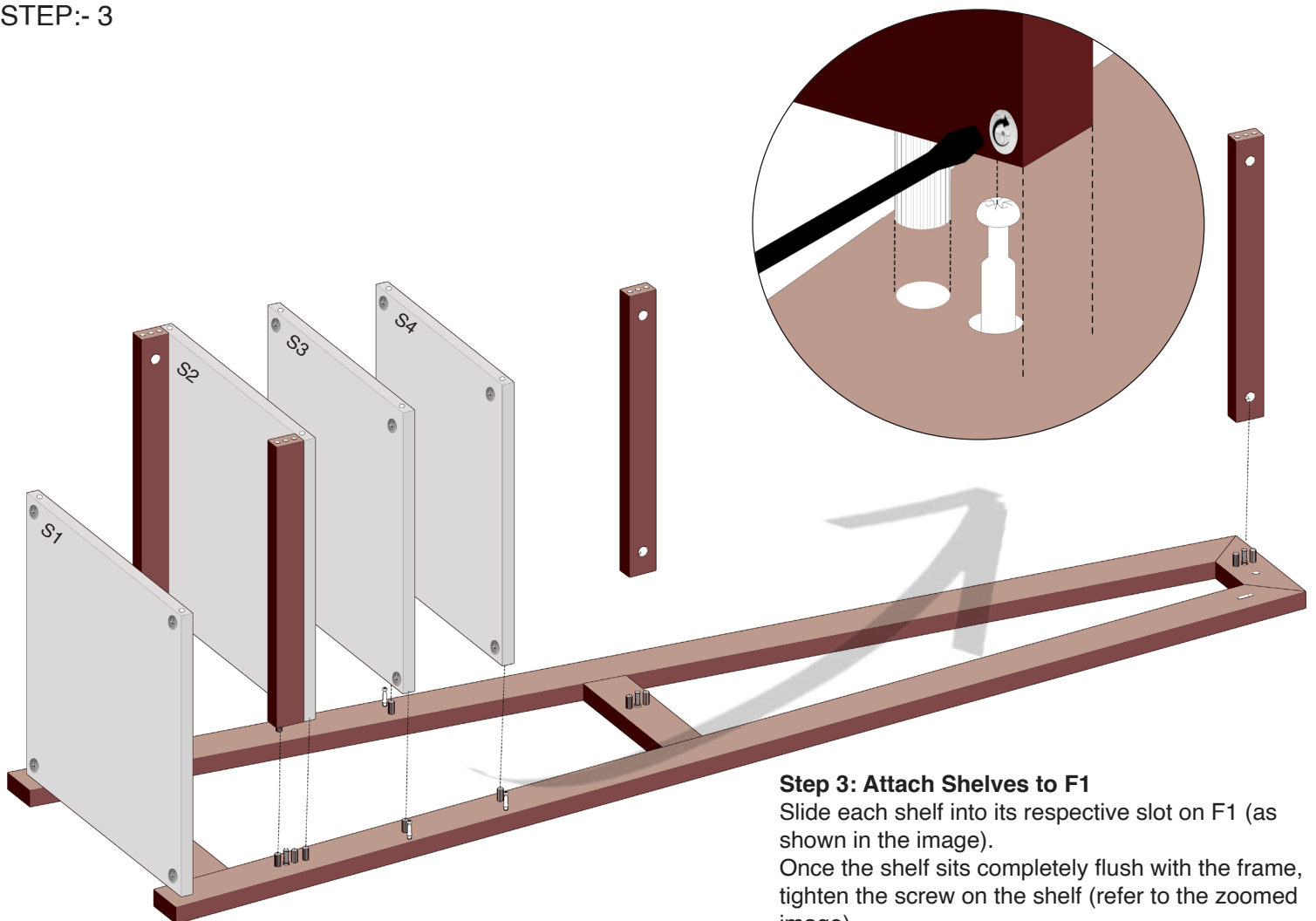

Step 3: Attach Shelves to F1

Slide each shelf into its respective slot on F1 (as shown in the image).

Once the shelf sits completely flush with the frame, tighten the screw on the shelf (refer to the zoomed image).

STEP:- 4

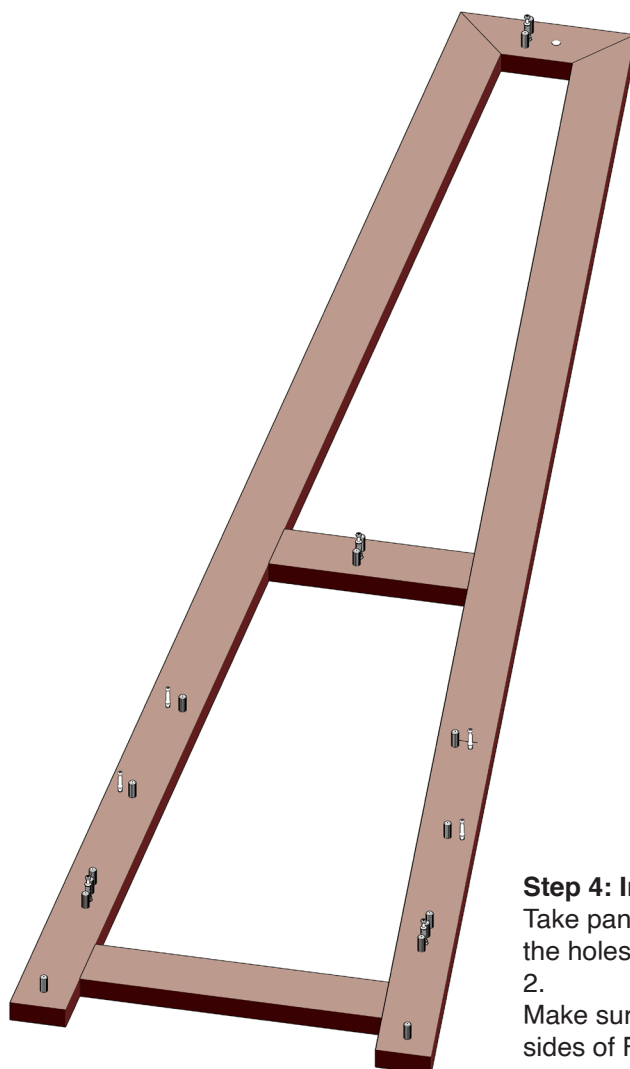
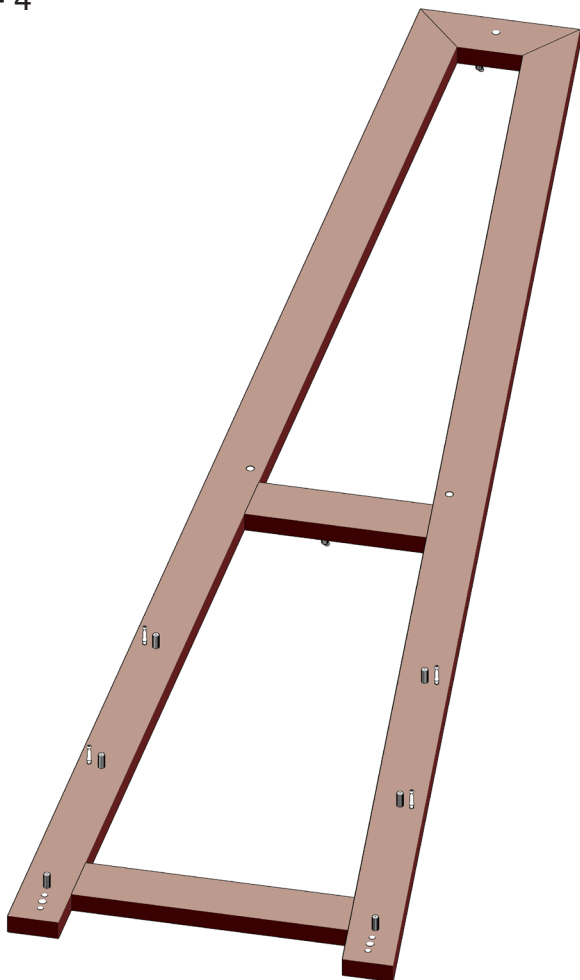

Step 4: Install Minifix Hardware on F2

Take panel F2 and insert the minifix hardware into the holes with white plastic fittings, just like in Step 2.

Make sure minifix hardware is attached on both sides of F2.

STEP:- 5

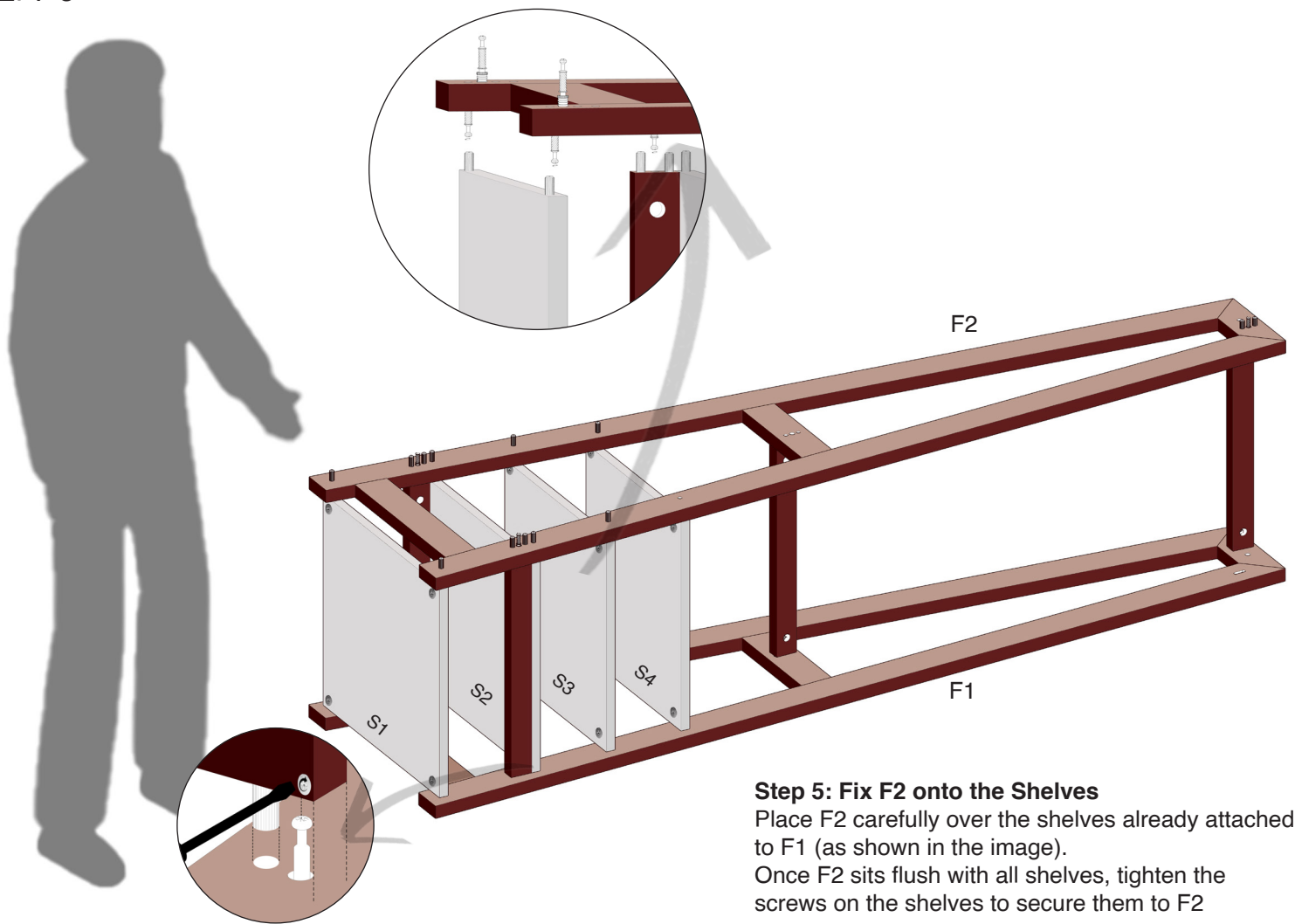

STEP:- 6

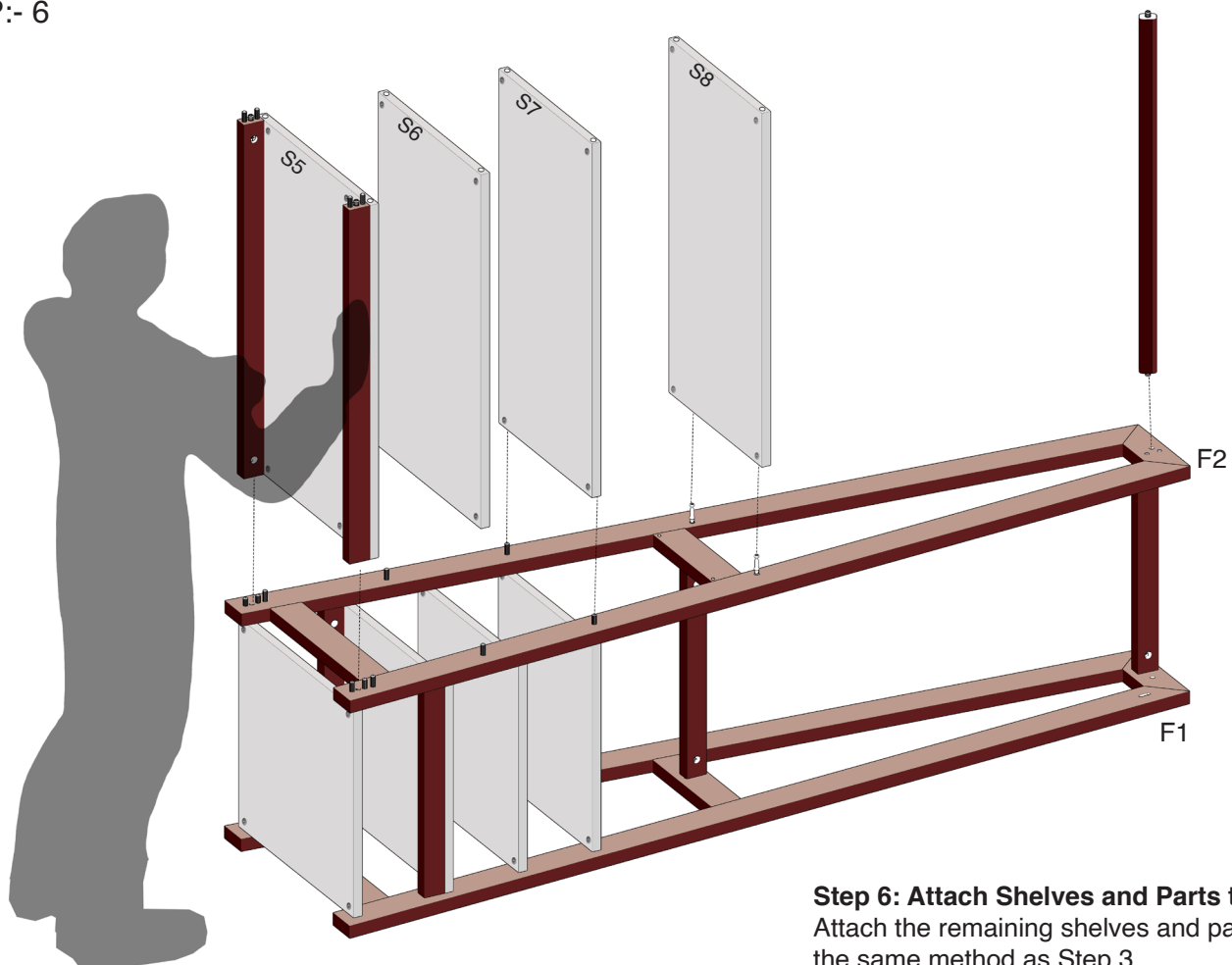

STEP:- 7

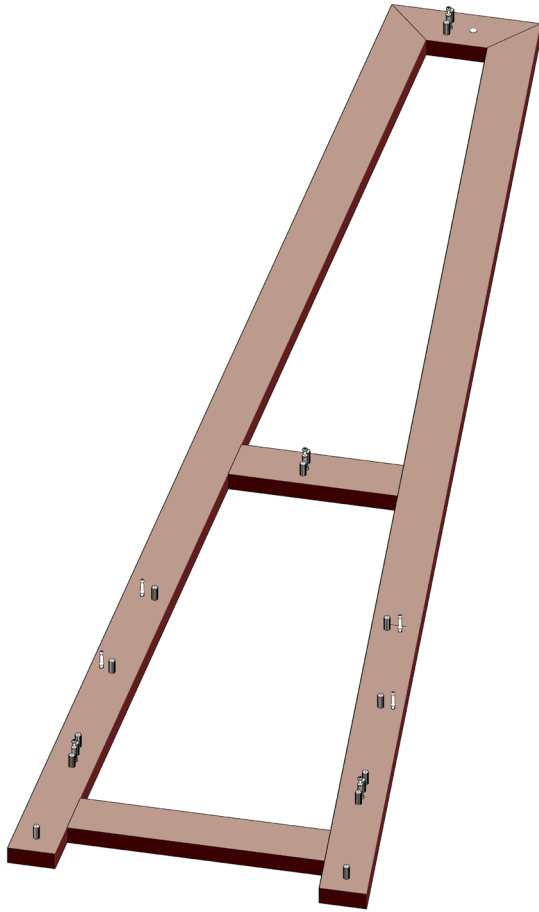

Step 7: Install Minifix Hardware on F3

Take panel F3 and attach the minifix hardware into the holes with white plastic fittings, the same way as Step 2.

STEP:- 8

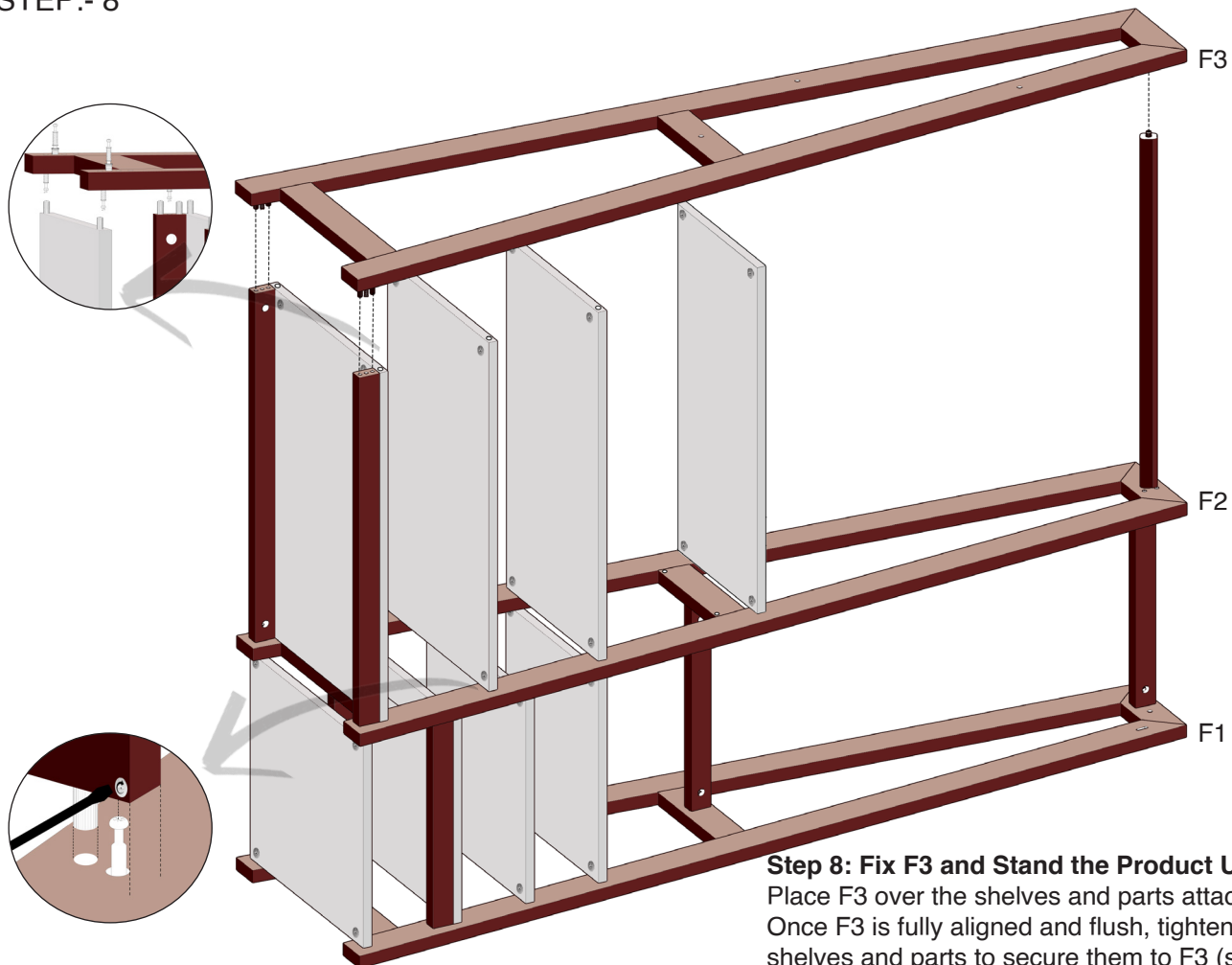

Step 8: Fix F3 and Stand the Product Upright

Place F3 over the shelves and parts attached to F2. Once F3 is fully aligned and flush, tighten the screws on the shelves and parts to secure them to F3 (same as Step 5).

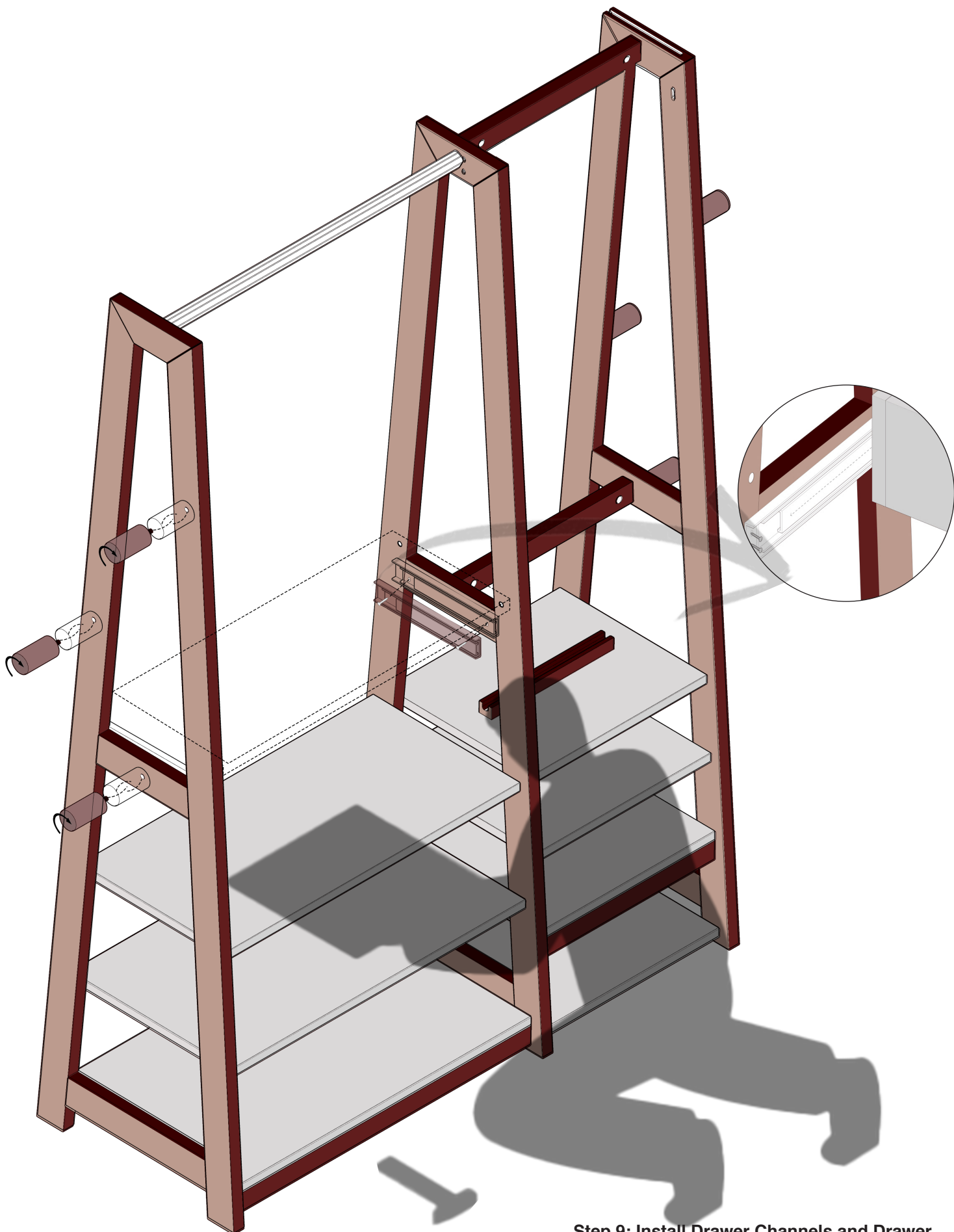

Step 9: Install Drawer Channels and Drawer

Attach the drawer channels into the slots shown in the image.

Once installed, slide the drawer smoothly into the channels. Attach 3 knobs on the right side of F1 and 3 knobs on the left side of F3 using the provided slots.

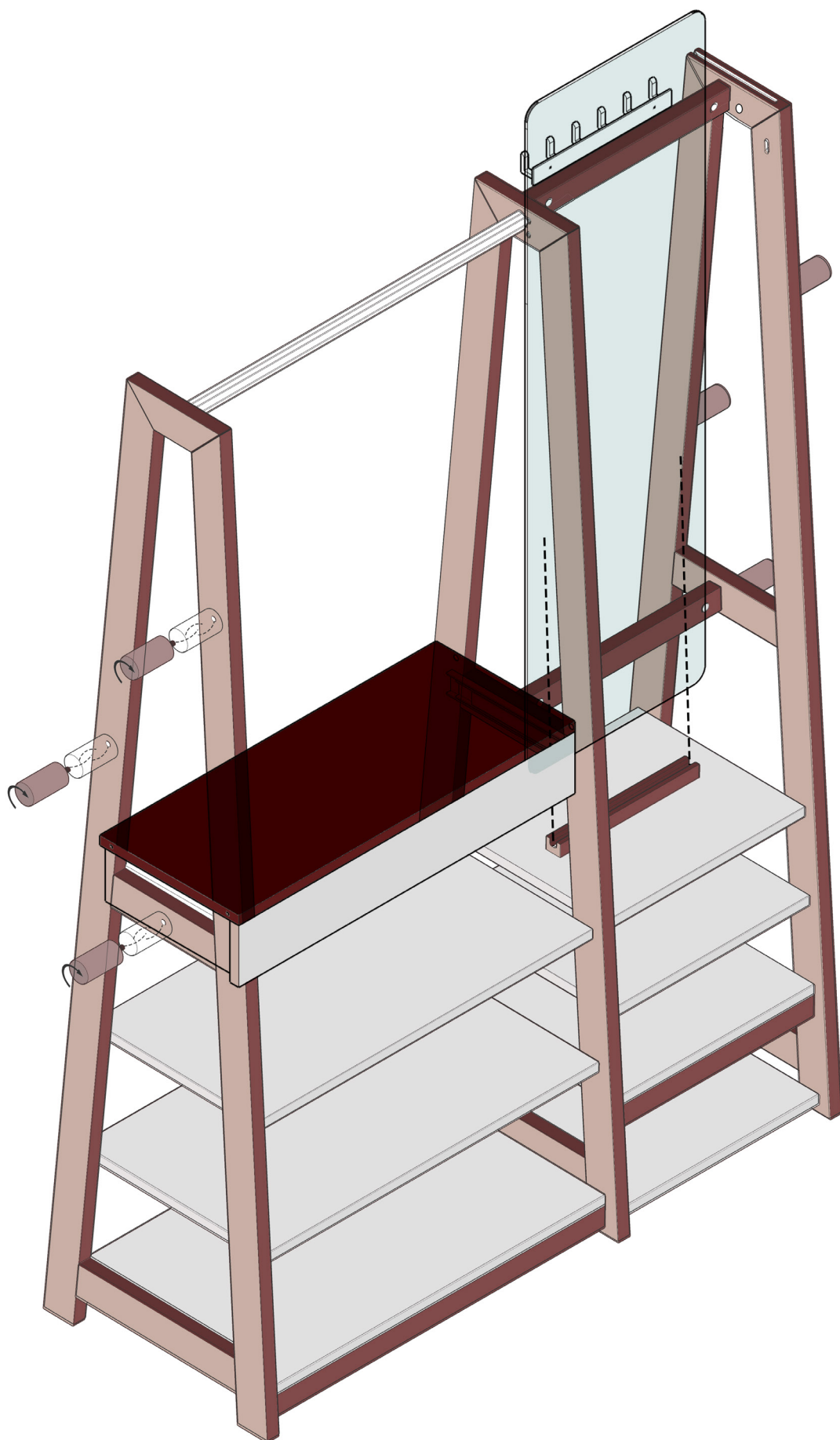

Step 10: Install the Mirror

Place the mirror upright into the designated slot (as shown in the image).

To secure it, attach two wooden knobs, one on each side of the mirror, and tighten them firmly.



Step 11: Install the Light Bar

Attach the light bar into the slots shown in the image. Route the wire neatly through the groove (channel) provided on the backside of panel F1. Twist each knob until securely tightened.

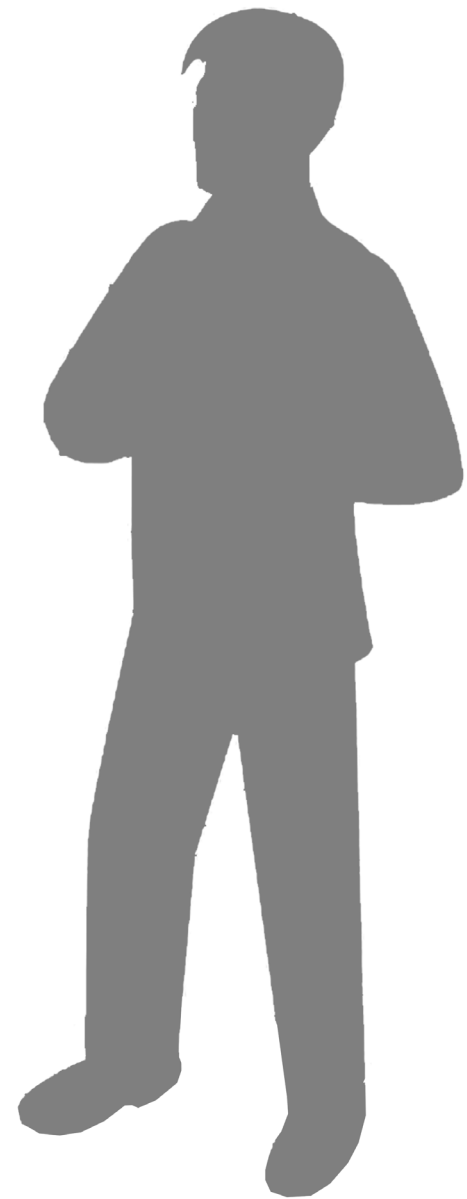

The final product is now ready for use. The shelves can be used for storage, and the mirror completes the vanity setup.

For any support, queries, or service assistance, please contact us at:

Email: team@urbanmodus.com

Phone: +91 9104192316

Website: www.urbanmodus.com